



Directional Parabolic Antenna



Tip: Pictures are for reference only.
Please refer to physical objects.

- Model: FTD-5158PW34V12A
- Name: Directional Parabolic Antenna
- Freq.Range: 5150 to 5850 MHz
- Communications system:
Remote communication,
5.1 to 5.8GHz WLAN/WIFI/ISM/UNII,
5.1 to 5.8GHz Spread Spectrum Communication
- Application scenario:
Point to point, Wireless bridging,
Long-distance communication,
Wireless data and image transmission,
IEEE802.11a/n

Electrical Specifications

Freq.Range-MHz	5150 to 5850
Bandwidth-MHz	700
Polarization	Vertical or Horizontal
Gain-dBi	34
Half-power beam width-°	H: 3 E: 3
F/B-dB	≥ 40
Impedance-Ω	50
VSWR	≤ 1.5
Max.Power-W	100
Lightning Protection	DC Grounded

Mechanical Specifications

Connector	N female
Connector Position	Back
Diameter-M	About Φ1.2
Weight-KG	About 28
Radome material	Aluminium alloy
Radome color	Gray
Mechanical tilt-°	0 to 20
Operational Temperature-°C	-40 to 60
Storage Temperature-°C	-55 to 85
Relative Humidity-%	5 to 95
Rated Wind Velocity-M/S	60
Mounting way	Mast
Mast Diameter-MM	Φ90 to 150



Installation Demonstrations

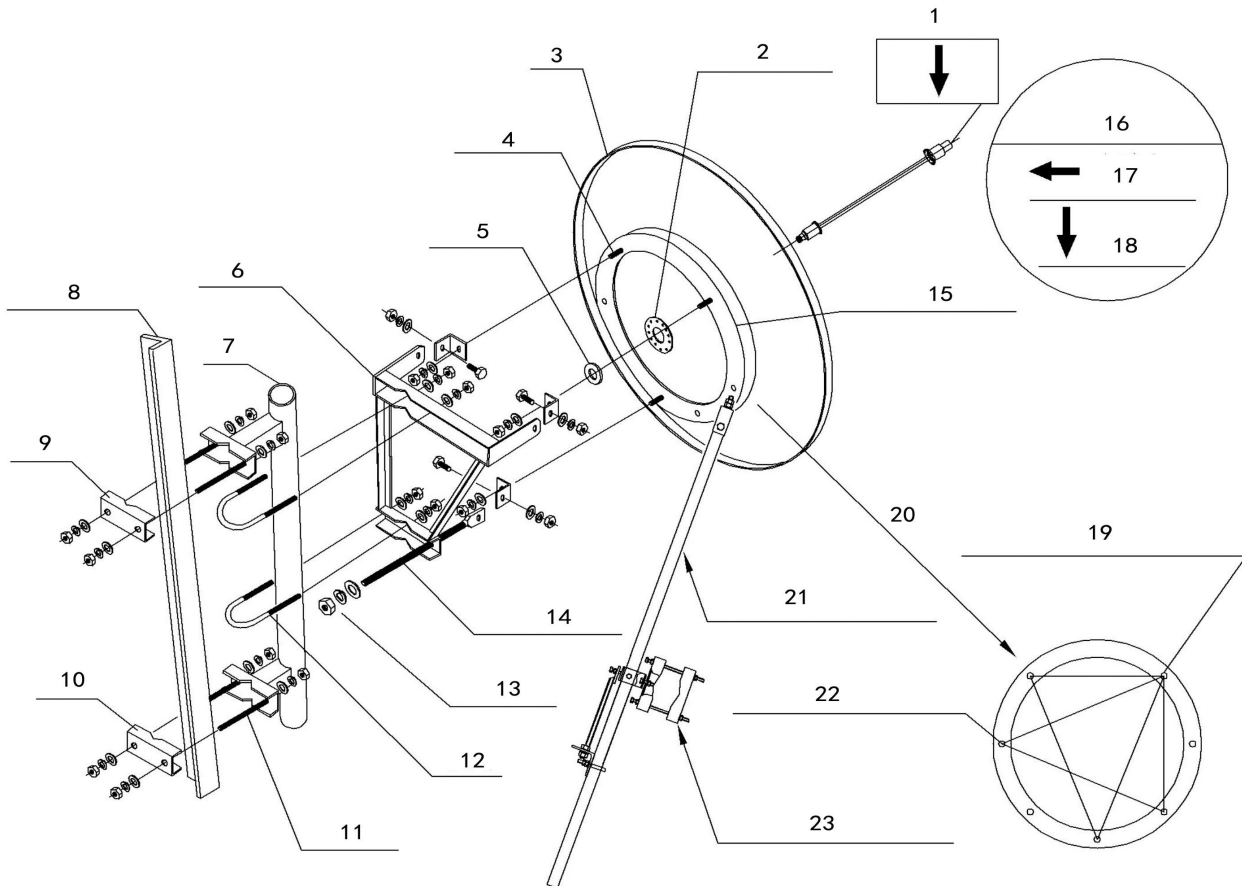

1	Polarization Mark	14	Pitch angle adjusting rod
2	Reflection centrosome	15	Reflective back ring
3	Reflecting surface	16	Polarization diagram
4	Fastening assembly	17	Horizontal polarization
5	Nut	18	Vertical polarization
6	Pylon	19	The three holes at the apex of the triangle are installation holes, and the three holes at the apex of another triangle can be used for polarization change.
7	Mast Supplied by customer		
8	Iron tower angle steel		
9	Seesaw	20	Reflection back view
10	Seesaw	21	Position angle adjusting rod
11	Fastening assembly	22	Installation hole position of position angle
12	“U”bolt	23	Installation component of position angle adjusting rod
13	Fastening assembly		